

SMD 30, 60 SERIES CONTINUOUS, FULL PERFORMANCE IN A COMPACT SIZE

SMD 30 and SMD 60 models are ideal for the drying of thermoplastic pellets and regrind before processing in order to remove all remaining moisture from the pellets both inside and out, independent of climate or ambient air conditions.

Sterling's SMD 30 and SMD 60 compressed air dryers offer full performance in a compact size. The dryer cabinet style is designed for maximum safety, and premium quality Incoloy® heaters provide dependable service. Sterling compressed air dryers are virtually maintenance free and are designed for 24 hour continuous operation.



Features

- High efficiency membrane to produce dry air (-40°F [-40°C]) without the use of desiccant
- Average dewpoint temperature of -40°F
- Mitsubishi programmable relay controller
- 1/16 DIN PID temperature controller
- Drying temperature of 110°-300° F (43°-149°C) (air supply temperature must be lower than process temperature)
- NFPA79, US and CUL machinery electrical standards, including NEMA 12 enclosure, nonfused electrical disconnect, solid state relay for heater control, branch fusing, and "Process High Temp" alarm light
- High process temperature safety
- Automatic shut-off system to monitor compressed air supply
- Dual compressed air filter assembly with dirty filter indicator and air pressure gauge
- Thermocouple for hopper inlet
- 12' high-temp silicone hose and two clamps
- Operates with 460/3/60 (other voltages available, consult factory)
- Full load amps (at 460/3/60): SMD 30 – 4.25; SMD 60 – 8
- Compressed air requirements; SMD 30 – 5 SCFM at 80 psi; SMD 60 – 10 SCFM at 80 psi
- Air inlet/outlet OD: SMD 30 – 2" (51 mm); SMD 60 - 2.5" (63 mm)
- Approximate weight: SMD 30 - 130 lbs (60 kgs); SMD 60 – 160 lbs (75 kgs)
- Capacity: SMD 30 – 30 cfm (50 m³/h); SMD 60 – 60 cfm (100 m³/h)

Options

- 12' insulated process hose
- Additional compressed air pre-filter assembly mounted on outside of dryer cabinet
- Exhaust air cartridge filter (350°F [177°C] maximum)
- Casters
- Dewpoint monitor (-40°F)
- Audible high process temperature alarm with reset button compliance: touch-safe fuse holders for Euro fuses, and touch-safe transformer
- Portable cart



SMD 30, 60 SERIES

SPECIFICATIONS

	SMD30				SMD60			
Process airflow, cfm (m ³ /hr)	30 (50)				60 (100)			
	1.7 (40)	3 (85)	4 (110)	6 (170)	3 (85)	4 (110)	6 (170)	9 (255)
Capacity @ 35 lbs./cu. ft.	50	100	150	200	100	150	200	300
Standard voltage	460/3/60							
Full Load Amps (430/3/60)	4.25				8			
Air Outlet O.D., in. (mm)	2.5 (64)				2.5 (64)			
Compressed air requirements SCFM @ 80 psi	5				10			
Width, in (mm)	22 (560)				25 (635)			
Depth, in (mm)	40 (1020)				47 (1195)			
Height, in (mm)	37.5 (955)	44.5 (1130)	50.5 (1285)	62.5 (1588)	44.5 (1130)	50.5 (1285)	62.5 (1590)	80.5 (2045)
Weight, lbs. (kg)	370 (168)	460 (204)	490 (222)	535 (243)	510 (231)	530 (240)	560 (254)	590 (268)

1 Consult factory for delivery

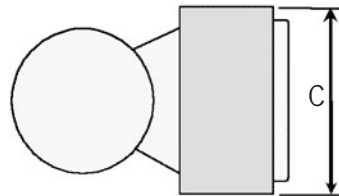
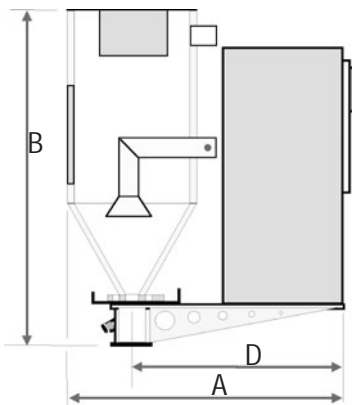

Mounting Flange:
 7" square
 5.5" square bolt pattern
 0.625" dia. bolt holes
 2" diameter discharge hole

Dimensions, in. (mm)	SMD30			SMD60			
A	40 (1020)			47 (1195)			
B	37.5 (955)	44.5 (1320)	50.5 (1285)	44.5 (1320)	50.5 (1285)	62.5 (1590)	70 (1778)
C	22 (560)			25 (635)			
D	28 (715)			38 (965)			

STANDARD CONTROLLER

