

## SSK 30, SSP 30 SERIES HIGH PERFORMANCE FILTER,

### Weld Flange

Clamp and gasket included

Model: EF430  
P/N: CTV66059

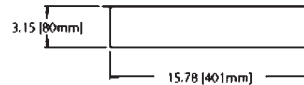

### Circular Bolt Flange

Clamp and gasket included

Model: MF430  
P/N: CTV66092

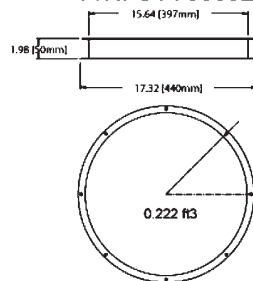

(8) - Ø.25 on  
16.77" BC

Model: A0569642K  
P/N: A0569642K

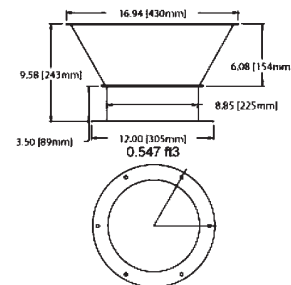

(6) - Ø.3125  
on 11" BC

### Dia. To Dia. Band Clamp Adapter

Clamp and gasket included

P/N: A0569138

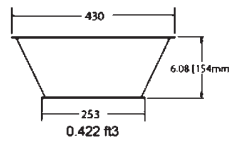

NOTE - This part  
does not come with  
clamp or gasket

Model: AD430-253  
P/N: CTV63614

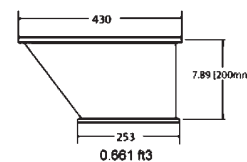

### 6x6 Sq. Machine Mount

Clamp and gasket included  
Slide gate included

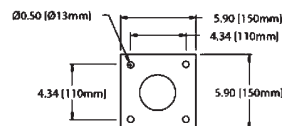

Model: VT23/100-A  
P/N: CT30127

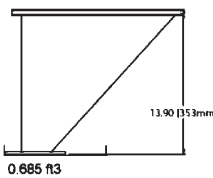

Model: VT25/100-S  
P/N: CT27309

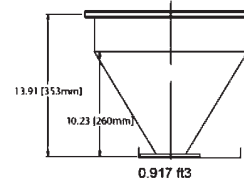

### Extension Sections

Clamp and gasket included

Model: EM50  
P/N: CTV63099

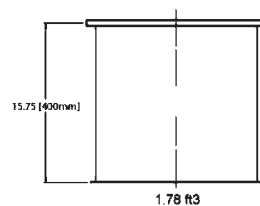

Model: EM25  
P/N: CTV63098

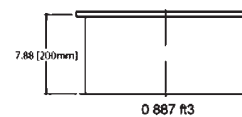

### Part Numbers

Clamp and T-Bolt: CT84940  
Gasket: CT28418  
Nut: CT26451



# SSK 30, SSP 30 SERIES

## SPECIFICATIONS

Model	Hopper Capacity, cu. ft. (l)	Hopper Capacity, lbs. (kg)	FLA	Shipping Weight, lbs. (kg)	Throughput - non-proportioning lbs./hr (kg/hr)*	Throughput - proportioning, lbs./hr (Kg/hr)*	Sight Glass Capacity, cu. ft. (l)	Sight Glass Capacity, lbs. (kg)
SSIL-03	0.1 (2.8)	3.5 (1.5)	11	50 (23)	150 (68)	N/A	0.02 (0.57)	0.68 (0.31)
SSL-06	0.2 (5.6)	7.0 (3.1)	10	65 (30)	500 (227)	400 (181)	N/A	N/A
SSIL-06	0.2 (5.6)	7.0 (3.1)	10	70 (32)	500 (227)	400 (181)	0.09 (2.55)	3.25 (1.48)
SSL-11	0.4 (11.3)	14.0 (6.3)	10	67 (31)	1000 (454)	800 (363)	N/A	N/A
SSIL-11	0.4 (11.3)	14.0 (6.3)	11	72 (33)	1000 (454)	800 (363)	0.09 (2.55)	3.25 (1.48)
SSL-23	0.8 (22)	24.0 (12.7)	10	75 (34)	1500 (680)	1200 (544)	N/A	N/A
SSL-45	1.6 (45)	56 (25.4)	10	80 (36)	1700 (771)	1350 (612)	N/A	N/A

## DIMENSIONS

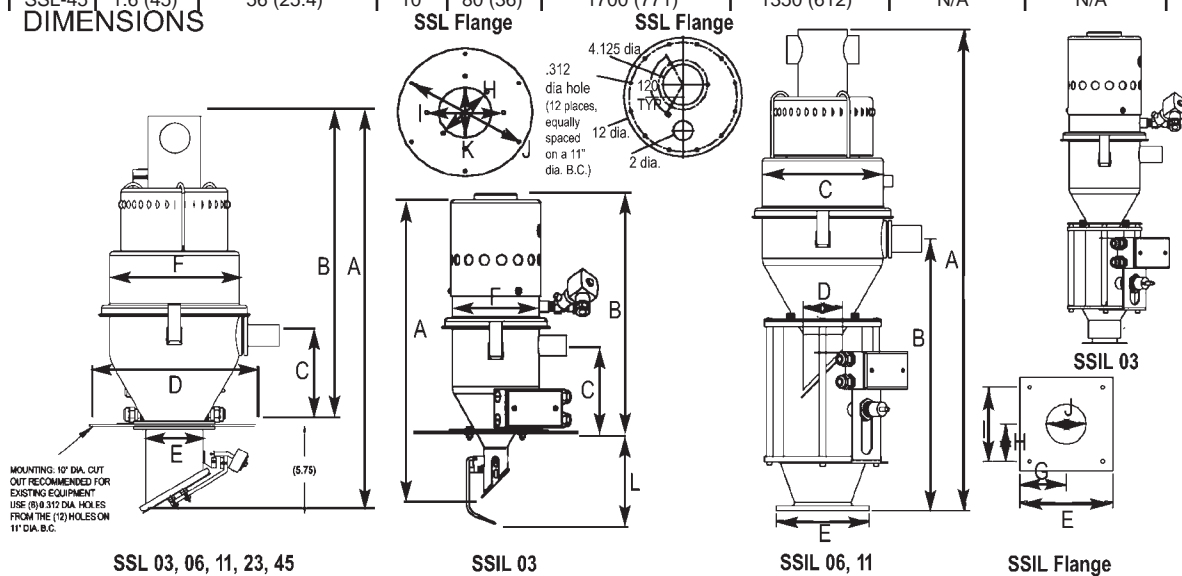

SSL Dimensions, in. (cm)											
Model	A	B	C	D	E	F	H1	I2	J3	K	L
SSL-03	24.625 (63)	17.16 (44)	6.375 (16)	12 (31)	1.75 (4)	6.375 (16)	5.5 (14)	6.8125 (17)	11 (28)	4.75 (12)	6.75 (17)
SSL-06	24.64 (63)	18.89 (48)	5.5 (14)	12 (31)	4 (10)	9.125 (23)	N/A	N/A	11 (28)	4.75 (12)	N/A
SSL-11	29.875 (76)	24.11 (61)	11.5 (29)	12 (31)	4 (10)	9.125 (23)	N/A	N/A	11 (28)	4.125 (11)	N/A
SSL-23	36 (92)	30.25 (77)	10.5 (27)	12 (31)	4 (10)	14.125 (36)	N/A	N/A	11 (28)	4.125 (11)	N/A
SSL-45	42.25 (107)	36.5 (93)	17.75 (45)	12 (31)	4 (10)	14.125 (36)	N/A	N/A	11 (28)	4.125 (11)	N/A

1) 5/16" (8 mm) dia. holes; 2 places, equally spaced    2) 5/18" (7 mm) dia. holes; 4 places equally spaced  
 3) 1/4" (6.3 mm) dia. holes; 6 places equally spaced (J is standard pattern)

SSIL Dimensions, in. (cm)									
Model	A	B	C	D	E	G	H	I4	J
SSIL-03	27.625 (70)	17 (43)	6.375 (16)	1.75 (4)	4 (10)	2 (5)	1.25 (3)	2.5 (6)	2 (5)
SSIL-06	35.25 (90)	19.5 (50)	9.125 (23)	3 (8)	7 (18)	3.5 (9)	2.75 (7)	5.5 (14)	3 (8)
SSIL-11	41.25 (105)	25.75 (65)	9.125 (23)	3 (8)	7 (18)	3.5 (9)	2.75 (7)	5.5 (14)	3 (8)

4) 0.281" (7.1 mm) dia. holes; 4 places equally spaced

